

MYERS PARK CENTER

1025 Providence Road
Charlotte, NC 28207

| TENANT | SQ. FT. |
|------------------------------|---------|
| Harris Teeter #12 | 15900 |
| Fancy Pants & Tootsies Too | 3,200 |
| The Charlotte Rug House | 3,110 |
| Paul Simon Company | 8,145 |
| Windsor Antiques | 1838 |
| Wolfman Pizza | 2500 |
| Myers Park Cleaners | 889 |
| Myers Park Nails and Spa | 1,132 |
| Colonial Barber Shop | 625 |
| Charles Wollin CPA | 1,580 |
| Aga Thyme | 1,320 |
| Myers Park Shoe Repair | 220 |
| Myers Park Alterations | 547 |
| Massage (Robinson/Thomasson) | 1,612 |
| Terry Huntley | 613 |
| Charlotte Insurance | 580 |

Total Square Footage
43,811

BASEMENT PLAN

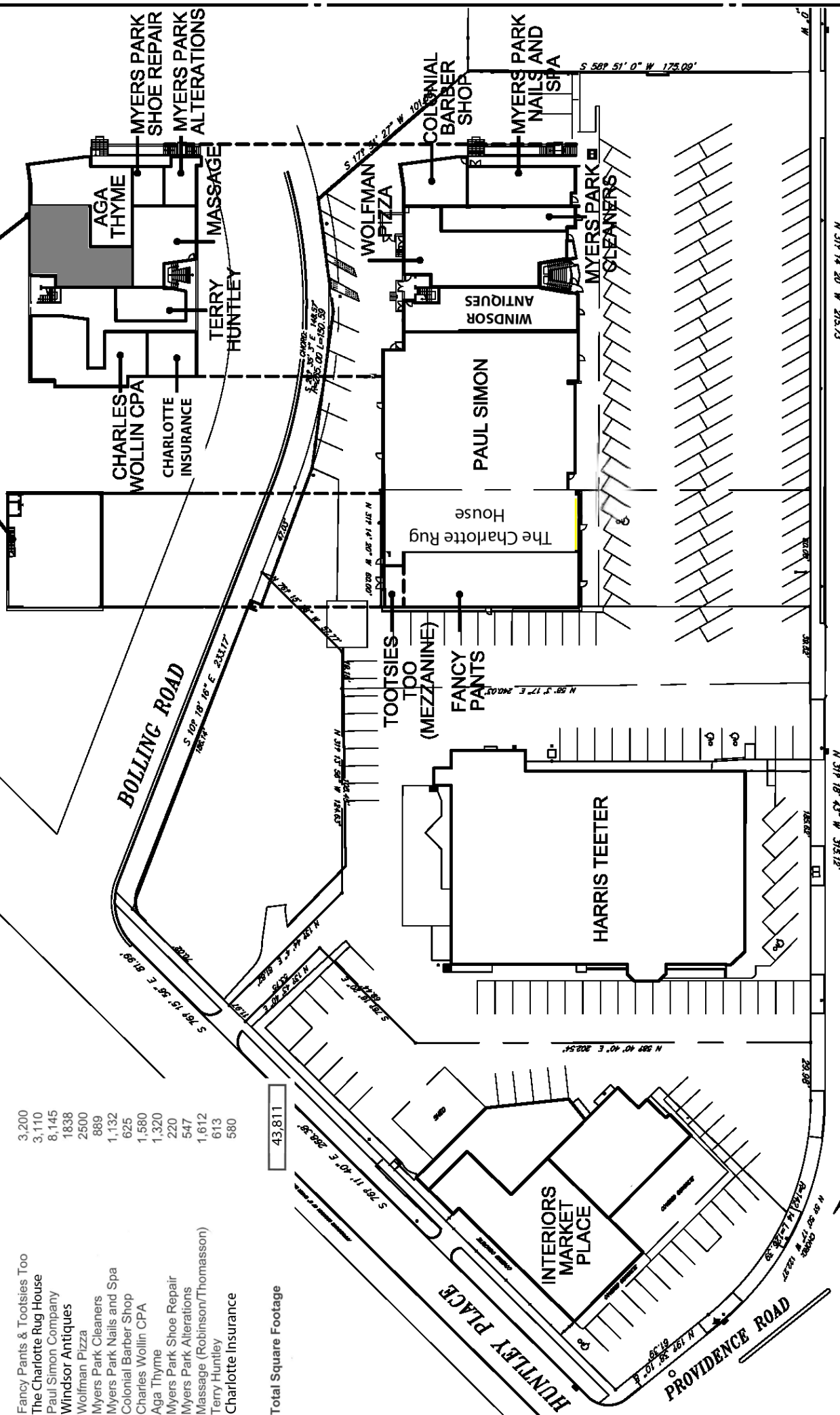

COLLETT & ASSOCIATES

1 SITE PLAN
SCALE: 1" = 50'-0"

PROVIDENCE ROAD

