

Brookshire Blvd (Hwy 16) & Mt. Holly-Huntersville Rd
Charlotte, NC



**4,500 SF
Restaurant
Space
Available**

Space is fully equipped
(bank owned equipment)



PROPERTY FEATURES

- GLA: 41,000 Sq. Ft.
- Endcap space
- 1/2 mile from new I-485 interchange
- Across the street from Wal-Mart Supercenter
- Existing Tenants: Bull & Barrister Draft House, Subway, UPS Store, Mountain Island Coffee House, H&R Block, Allstate, Edward Jones, Lily Cleaners, Niyoshi Japanese Restaurant, Veterinarian, Upscale Nails, Great Clips

TRAFFIC COUNTS

Brookshire Bv east of Mt Holly-Huntersville: 32,400 ADT
Mt Holly-Huntersville Rd @Wal-Mart: 19,800 ADT

DEMOGRAPHICS

	<u>1 mile</u>	<u>3 miles</u>	<u>5 miles</u>
Population:	3,543	24,462	62,531
2014 Estimate:	4,419	30,224	74,021
Avg HH Inc:	\$88,035	\$76,000	\$65,507

FOR ADDITIONAL INFORMATION CONTACT:

Spencer Brown
(704) 206-8326 - direct
sbrown@collett.biz

www.collett.biz

1111 Metropolitan Avenue #700
Charlotte, NC 28204
(704) 206-8300

Brookshire Blvd (Hwy 16) & Mt. Holly-Huntersville RD
Charlotte, NC

Callabridge Commons Shopping Center

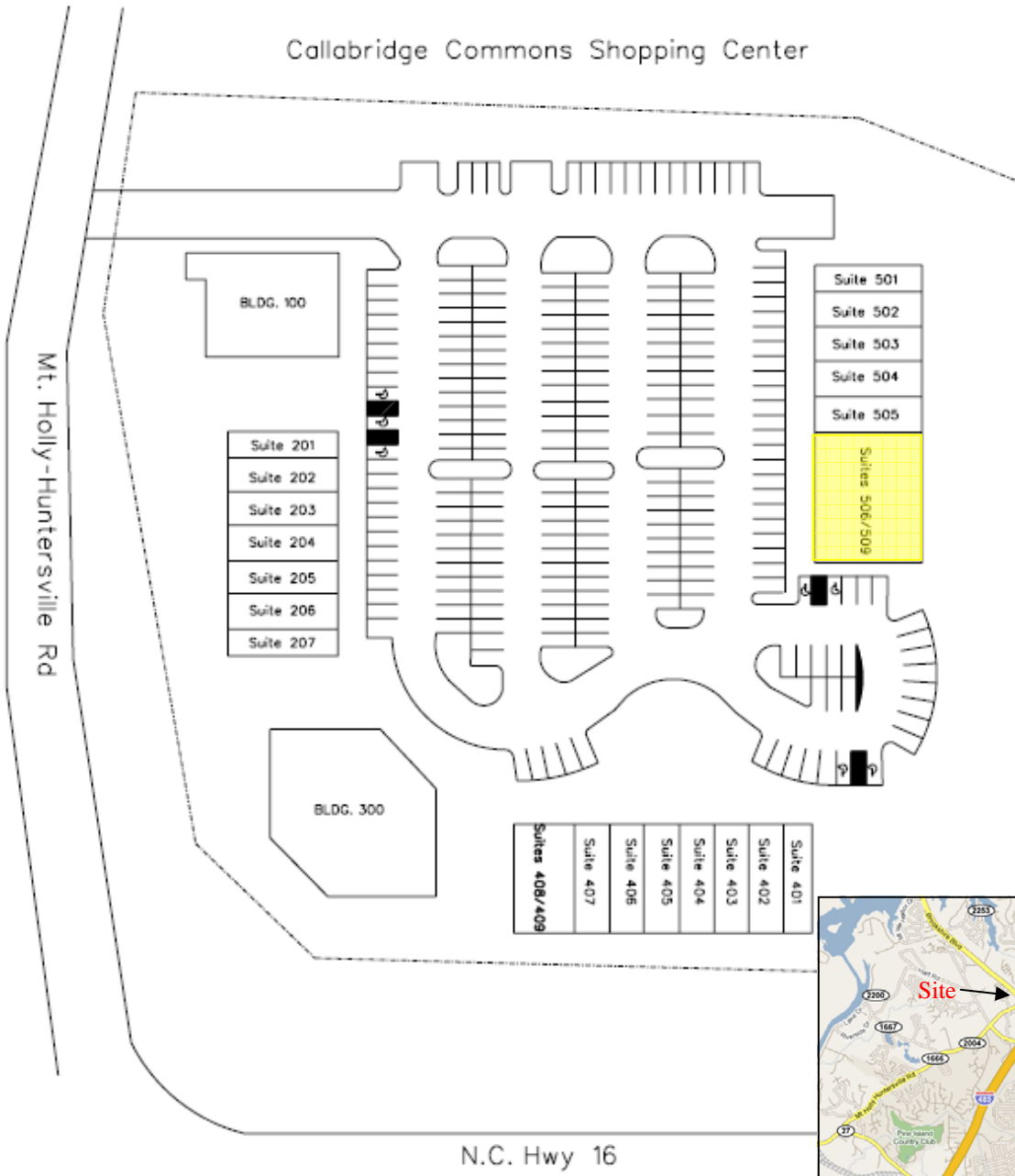

TENANTS

- 100. Allen Tate
- 201. Mountain Island Coffee
- 202. AVAILABLE 1,200 SF
- 203. SALON AVAILABLE 1,200 SF
- 204. UPS Store
- 205. T-Mobile
- 206. Subway
- 207. Great Clips
- 300. Bull & Barrister Draft House
- 401. Upscale Nails
- 402. AVAILABLE 1,200 SF
- 403. H&R Block
- 404. Avon
- 405. Allstate
- 406. Total Bond Veterinary
- 407. AT&T
- 408/409. Niyoshi Japanese
- 501. Edward Jones
- 502. Lily Cleaners
- 503-505. AVAILABLE 1,200 - 3,600 SF
- 506-509. AVAILABLE RESTAURANT 4,500 SF

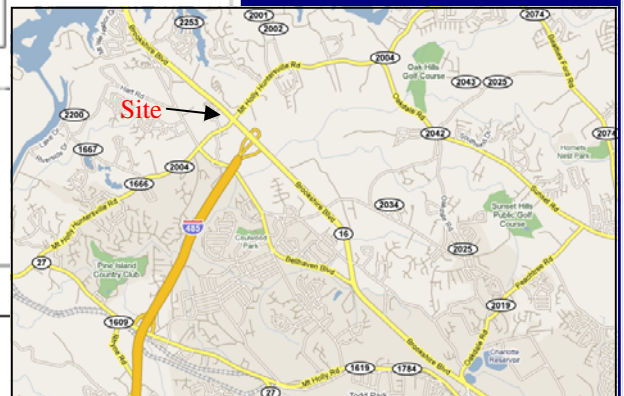

FOR ADDITIONAL INFORMATION CONTACT:

Spencer Brown
(704) 206-8326 - direct
sbrown@collett.biz

www.collett.biz

1111 Metropolitan Avenue #700
Charlotte, NC 28204
(704) 206-8300

Brookshire Blvd (Hwy 16) & Mt. Holly-Huntersville RD
Charlotte, NC

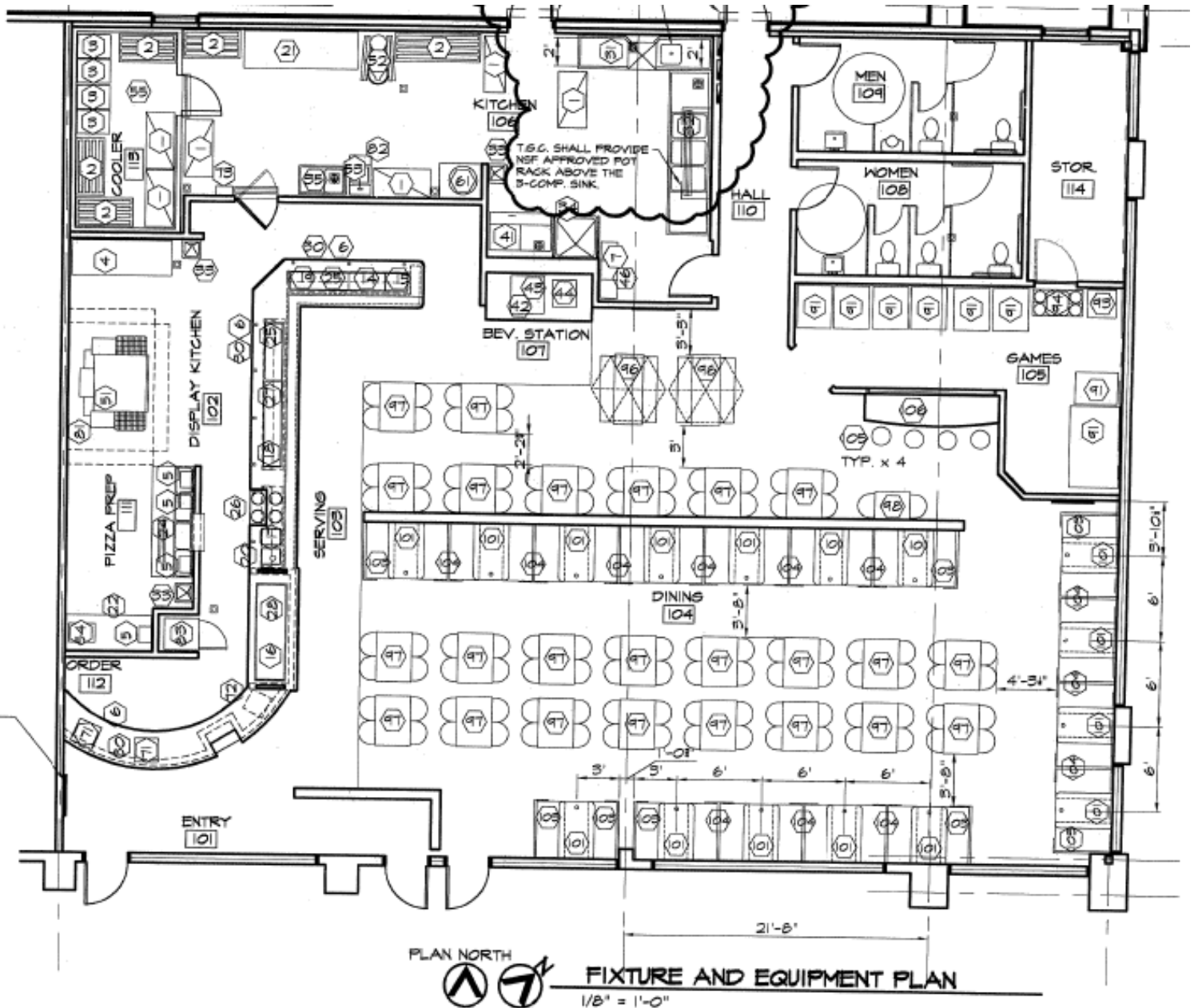

FOR ADDITIONAL INFORMATION CONTACT:

Spencer Brown
(704) 206-8326 - direct
sbrown@collett.biz

www.collett.biz

1111 Metropolitan Avenue #700
Charlotte, NC 28204
(704) 206-8300

Brookshire Blvd (Hwy 16) & Mt. Holly-Huntersville RD
Charlotte, NC



FOR ADDITIONAL INFORMATION CONTACT:

Spencer Brown
(704) 206-8326 - direct
sbrown@collett.biz

www.collett.biz

1111 Metropolitan Avenue #700
Charlotte, NC 28204
(704) 206-8300

Information furnished regarding this property was obtained from sources deemed reliable but no warranty or representation is made of the accuracy thereof. Properties are subject to sale, lease or withdrawal.

Pop-Facts: Demographic Snapshot Report

Radius 1: BROOKSHIRE BLVD AT MOUNT HOLLY HUNTERSVILLE RD, CHARLOTTE, NC 28216, aggregate

Radius 2: BROOKSHIRE BLVD AT MOUNT HOLLY HUNTERSVILLE RD, CHARLOTTE, NC 28216, aggregate

Radius 3: BROOKSHIRE BLVD AT MOUNT HOLLY HUNTERSVILLE RD, CHARLOTTE, NC 28216, aggregate

Description	0.00 - 1.00 miles		0.00 - 3.00 miles		0.00 - 5.00 miles	
	Radius 1	%	Radius 2	%	Radius 3	%
Population						
2014 Projection	4,419		30,224		74,021	
2009 Estimate	3,543		24,462		62,531	
2000 Census	1,869		13,485		41,337	
1990 Census	823		7,781		29,200	
Growth 2009-2014	24.72%		23.55%		18.37%	
Growth 2000-2009	89.57%		81.40%		51.27%	
Growth 1990-2000	127.10%		73.31%		41.57%	

2009 Est. Population by Single Race Classification	3,543.00		24,462.00		62,531.00	
White Alone	2,738	77.28	17,130	70.03	38,741	61.95
Black or African American Alone	632	17.84	5,933	24.25	19,134	30.60
American Indian and Alaska Native Alone	10	0.28	79	0.32	279	0.45
Asian Alone	96	2.71	596	2.44	2,134	3.41
Native Hawaiian and Other Pacific Islander Alone	0	0.00	5	0.02	43	0.07
Some Other Race Alone	35	0.99	397	1.62	1,146	1.83
Two or More Races	32	0.90	322	1.32	1,054	1.69

2009 Est. Population Hispanic or Latino by Origin*	3,543.00		24,462.00		62,531.00	
Not Hispanic or Latino	3,441	97.12	23,476	95.97	59,689	95.46
Hispanic or Latino:	103	2.91	986	4.03	2,842	4.54
Mexican	36	34.95	507	51.42	1,531	53.87
Puerto Rican	15	14.56	122	12.37	315	11.08
Cuban	7	6.80	34	3.45	100	3.52
All Other Hispanic or Latino	44	42.72	323	32.76	897	31.56

2009 Est. Hispanic or Latino by Single Race Class.	103.00		986.00		2,842.00	
White Alone	64	62.14	532	53.96	1,387	48.80
Black or African American Alone	2	1.94	34	3.45	102	3.59
American Indian and Alaska Native Alone	0	0.00	0	0.00	26	0.91
Asian Alone	0	0.00	0	0.00	27	0.95
Native Hawaiian and Other Pacific Islander Alone	0	0.00	5	0.51	7	0.25
Some Other Race Alone	33	32.04	374	37.93	1,087	38.25
Two or More Races	3	2.91	41	4.16	205	7.21



Pop-Facts: Demographic Snapshot Report

Radius 1: BROOKSHIRE BLVD AT MOUNT HOLLY HUNTERSVILLE RD, CHARLOTTE, NC 28216, aggregate

Radius 2: BROOKSHIRE BLVD AT MOUNT HOLLY HUNTERSVILLE RD, CHARLOTTE, NC 28216, aggregate

Radius 3: BROOKSHIRE BLVD AT MOUNT HOLLY HUNTERSVILLE RD, CHARLOTTE, NC 28216, aggregate

Description	0.00 - 1.00 miles		0.00 - 3.00 miles		0.00 - 5.00 miles	
	Radius 1	%	Radius 2	%	Radius 3	%
2009 Est. Pop. Asian Alone Race by Category*	96.00		596.00		2,134.00	
Chinese, except Taiwanese	10	10.42	52	8.72	142	6.65
Filipino	4	4.17	20	3.36	54	2.53
Japanese	1	1.04	3	0.50	21	0.98
Asian Indian	16	16.67	59	9.90	205	9.61
Korean	5	5.21	34	5.70	99	4.64
Vietnamese	22	22.92	165	27.68	611	28.63
Cambodian	0	0.00	23	3.86	57	2.67
Hmong	12	12.50	63	10.57	156	7.31
Laotian	26	27.08	152	25.50	646	30.27
Thai	0	0.00	0	0.00	5	0.23
Other Asian	1	1.04	14	2.35	87	4.08
Two or more Asian categories	0	0.00	11	1.85	51	2.39

2009 Est. Population by Ancestry						
	3,543.00		24,462.00		62,531.00	
Pop, Arab	2	0.06	17	0.07	53	0.08
Pop, Czech	4	0.11	14	0.06	82	0.13
Pop, Danish	0	0.00	0	0.00	31	0.05
Pop, Dutch	19	0.54	152	0.62	472	0.75
Pop, English	216	6.10	1,389	5.68	3,121	4.99
Pop, French (except Basque)	26	0.73	217	0.89	416	0.67
Pop, French Canadian	3	0.08	23	0.09	99	0.16
Pop, German	286	8.07	1,881	7.69	4,424	7.07
Pop, Greek	5	0.14	43	0.18	82	0.13
Pop, Hungarian	17	0.48	82	0.34	140	0.22
Pop, Irish	262	7.39	1,556	6.36	3,089	4.94
Pop, Italian	105	2.96	658	2.69	1,264	2.02
Pop, Lithuanian	1	0.03	26	0.11	39	0.06
Pop, United States or American	512	14.45	3,669	15.00	8,141	13.02
Pop, Norwegian	29	0.82	168	0.69	248	0.40
Pop, Polish	31	0.87	182	0.74	444	0.71
Pop, Portuguese	0	0.00	0	0.00	9	0.01
Pop, Russian	5	0.14	52	0.21	105	0.17
Pop, Scottish	65	1.83	426	1.74	848	1.36
Pop, Scotch-Irish	210	5.93	1,297	5.30	2,614	4.18
Pop, Slovak	1	0.03	14	0.06	27	0.04
Pop, Sub-Saharan African	37	1.04	167	0.68	646	1.03
Pop, Swedish	9	0.25	76	0.31	159	0.25
Pop, Swiss	12	0.34	61	0.25	79	0.13
Pop, Ukrainian	3	0.08	13	0.05	32	0.05
Pop, Welsh	8	0.23	37	0.15	120	0.19
Pop, West Indian (exc Hisp groups)	3	0.08	27	0.11	160	0.26



Pop-Facts: Demographic Snapshot Report

Radius 1: BROOKSHIRE BLVD AT MOUNT HOLLY HUNTERSVILLE RD, CHARLOTTE, NC 28216, aggregate

Radius 2: BROOKSHIRE BLVD AT MOUNT HOLLY HUNTERSVILLE RD, CHARLOTTE, NC 28216, aggregate

Radius 3: BROOKSHIRE BLVD AT MOUNT HOLLY HUNTERSVILLE RD, CHARLOTTE, NC 28216, aggregate

Description	0.00 - 1.00 miles <i>Radius 1</i>		0.00 - 3.00 miles <i>Radius 2</i>		0.00 - 5.00 miles <i>Radius 3</i>	
	%	%	%	%	%	%
2009 Est. Population by Ancestry						
Pop, Other ancestries	688	19.42	5,739	23.46	18,687	29.88
Pop, Ancestry Unclassified	985	27.80	6,476	26.47	16,901	27.03
2009 Est. Pop Age 5+ by Language Spoken At Home						
Speak Only English at Home	3,049	93.99	20,898	93.42	53,720	93.42
Speak Asian/Pacific Islander Language at Home	49	1.51	314	1.40	1,105	1.92
Speak IndoEuropean Language at Home	92	2.84	545	2.44	1,076	1.87
Speak Spanish at Home	44	1.36	557	2.49	1,435	2.50
Speak Other Language at Home	10	0.31	57	0.25	164	0.29
2009 Est. Population by Sex						
Male	1,746	49.28	11,968	48.92	30,551	48.86
Female	1,798	50.75	12,495	51.08	31,980	51.14
Male/Female Ratio	0.97		0.96		0.96	
2009 Est. Population by Age						
Age 0 - 4	299	8.44	2,092	8.55	5,030	8.04
Age 5 - 9	283	7.99	1,960	8.01	4,766	7.62
Age 10 - 14	263	7.42	1,769	7.23	4,362	6.98
Age 15 - 17	165	4.66	1,061	4.34	2,687	4.30
Age 18 - 20	118	3.33	784	3.20	2,096	3.35
Age 21 - 24	164	4.63	1,135	4.64	2,884	4.61
Age 25 - 34	287	8.10	2,161	8.83	6,650	10.63
Age 35 - 44	645	18.20	4,370	17.86	10,690	17.10
Age 45 - 49	324	9.14	2,113	8.64	5,132	8.21
Age 50 - 54	272	7.68	1,774	7.25	4,464	7.14
Age 55 - 59	232	6.55	1,463	5.98	3,883	6.21
Age 60 - 64	176	4.97	1,186	4.85	3,187	5.10
Age 65 - 74	201	5.67	1,577	6.45	4,032	6.45
Age 75 - 84	86	2.43	782	3.20	2,022	3.23
Age 85 and over	27	0.76	236	0.96	647	1.03
Age 16 and over	2,641	74.54	18,222	74.49	47,415	75.83
Age 18 and over	2,534	71.52	17,581	71.87	45,686	73.06
Age 21 and over	2,415	68.16	16,797	68.67	43,590	69.71
Age 65 and over	314	8.86	2,595	10.61	6,700	10.71
2009 Est. Median Age						
	37.98		37.91		37.61	
2009 Est. Average Age						
	35.76		36.22		36.51	



Pop-Facts: Demographic Snapshot Report

Radius 1: BROOKSHIRE BLVD AT MOUNT HOLLY HUNTERSVILLE RD, CHARLOTTE, NC 28216, aggregate

Radius 2: BROOKSHIRE BLVD AT MOUNT HOLLY HUNTERSVILLE RD, CHARLOTTE, NC 28216, aggregate

Radius 3: BROOKSHIRE BLVD AT MOUNT HOLLY HUNTERSVILLE RD, CHARLOTTE, NC 28216, aggregate

Description	0.00 - 1.00 miles		0.00 - 3.00 miles		0.00 - 5.00 miles	
	Radius 1	%	Radius 2	%	Radius 3	%
2009 Est. Male Population by Age	1,746.00		11,968.00		30,551.00	
Age 0 - 4	151	8.65	1,056	8.82	2,567	8.40
Age 5 - 9	145	8.30	1,003	8.38	2,457	8.04
Age 10 - 14	136	7.79	907	7.58	2,253	7.37
Age 15 - 17	85	4.87	539	4.50	1,388	4.54
Age 18 - 20	56	3.21	385	3.22	1,065	3.49
Age 21 - 24	84	4.81	558	4.66	1,498	4.90
Age 25 - 34	130	7.45	1,000	8.36	3,142	10.28
Age 35 - 44	320	18.33	2,188	18.28	5,249	17.18
Age 45 - 49	160	9.16	1,033	8.63	2,494	8.16
Age 50 - 54	132	7.56	855	7.14	2,161	7.07
Age 55 - 59	121	6.93	728	6.08	1,879	6.15
Age 60 - 64	85	4.87	573	4.79	1,494	4.89
Age 65 - 74	96	5.50	733	6.12	1,863	6.10
Age 75 - 84	36	2.06	328	2.74	829	2.71
Age 85 and over	9	0.52	81	0.68	212	0.69
2009 Est. Median Age, Male	37.69		37.45		36.73	
2009 Est. Average Age, Male	35.18		35.46		35.47	
2009 Est. Female Population by Age	1,798.00		12,495.00		31,980.00	
Age 0 - 4	148	8.23	1,035	8.28	2,463	7.70
Age 5 - 9	137	7.62	956	7.65	2,309	7.22
Age 10 - 14	127	7.06	863	6.91	2,110	6.60
Age 15 - 17	80	4.45	522	4.18	1,299	4.06
Age 18 - 20	63	3.50	399	3.19	1,031	3.22
Age 21 - 24	80	4.45	576	4.61	1,386	4.33
Age 25 - 34	158	8.79	1,161	9.29	3,507	10.97
Age 35 - 44	326	18.13	2,182	17.46	5,441	17.01
Age 45 - 49	164	9.12	1,080	8.64	2,639	8.25
Age 50 - 54	141	7.84	919	7.35	2,303	7.20
Age 55 - 59	112	6.23	735	5.88	2,003	6.26
Age 60 - 64	91	5.06	613	4.91	1,693	5.29
Age 65 - 74	105	5.84	844	6.75	2,169	6.78
Age 75 - 84	50	2.78	453	3.63	1,193	3.73
Age 85 and over	18	1.00	155	1.24	435	1.36
2009 Est. Median Age, Female	38.29		38.37		38.47	
2009 Est. Average Age, Female	36.32		36.95		37.50	



Pop-Facts: Demographic Snapshot Report

Radius 1: BROOKSHIRE BLVD AT MOUNT HOLLY HUNTERSVILLE RD, CHARLOTTE, NC 28216, aggregate

Radius 2: BROOKSHIRE BLVD AT MOUNT HOLLY HUNTERSVILLE RD, CHARLOTTE, NC 28216, aggregate

Radius 3: BROOKSHIRE BLVD AT MOUNT HOLLY HUNTERSVILLE RD, CHARLOTTE, NC 28216, aggregate

Description	0.00 - 1.00 miles		0.00 - 3.00 miles		0.00 - 5.00 miles	
	Radius 1	%	Radius 2	%	Radius 3	%
2009 Est. Population Age 15+ by Marital Status*	2,699.00		18,642.00		48,373.00	
Total, Never Married	482	17.86	3,394	18.21	10,126	20.93
Married, Spouse present	1,877	69.54	12,515	67.13	29,436	60.85
Married, Spouse absent	63	2.33	544	2.92	2,008	4.15
Widowed	104	3.85	886	4.75	2,515	5.20
Divorced	174	6.45	1,303	6.99	4,289	8.87
Males, Never Married	266	9.86	2,004	10.75	5,587	11.55
Previously Married	73	2.70	537	2.88	1,970	4.07
Females, Never Married	216	8.00	1,390	7.46	4,539	9.38
Previously Married	204	7.56	1,652	8.86	4,833	9.99

2009 Est. Pop. Age 25+ by Educational Attainment*	2,251.00		15,663.00		40,706.00	
Less than 9th grade	46	2.04	434	2.77	1,643	4.04
Some High School, no diploma	256	11.37	1,632	10.42	4,848	11.91
High School Graduate (or GED)	570	25.32	4,358	27.82	11,719	28.79
Some College, no degree	516	22.92	3,958	25.27	10,684	26.25
Associate Degree	162	7.20	1,172	7.48	2,878	7.07
Bachelor's Degree	527	23.41	3,198	20.42	6,963	17.11
Master's Degree	116	5.15	620	3.96	1,411	3.47
Professional School Degree	48	2.13	218	1.39	406	1.00
Doctorate Degree	11	0.49	72	0.46	153	0.38

Households

2014 Projection	1,660		11,554		28,571	
2009 Estimate	1,334		9,383		24,124	
2000 Census	699		5,160		15,819	
1990 Census	312		3,017		10,995	
Growth 2009-2014	24.44%		23.14%		18.43%	
Growth 2000-2009	90.84%		81.84%		52.50%	
Growth 1990-2000	124.04%		71.03%		43.87%	

2009 Est. Households by Household Type	1,334.00		9,383.00		24,124.00	
Family Households	1,029	77.14	7,031	74.93	17,652	73.17
Nonfamily Households	304	22.79	2,352	25.07	6,472	26.83

2009 Est. Group Quarters Population	2.00		23.00		311.00	
--	------	--	-------	--	--------	--

2009 Households by Ethnicity, Hispanic/Latino	25.00	1.87	237.00	2.53	693.00	2.87
--	-------	------	--------	------	--------	------



Pop-Facts: Demographic Snapshot Report

Radius 1: BROOKSHIRE BLVD AT MOUNT HOLLY HUNTERSVILLE RD, CHARLOTTE, NC 28216, aggregate

Radius 2: BROOKSHIRE BLVD AT MOUNT HOLLY HUNTERSVILLE RD, CHARLOTTE, NC 28216, aggregate

Radius 3: BROOKSHIRE BLVD AT MOUNT HOLLY HUNTERSVILLE RD, CHARLOTTE, NC 28216, aggregate

Description	0.00 - 1.00 miles		0.00 - 3.00 miles		0.00 - 5.00 miles	
	Radius 1	%	Radius 2	%	Radius 3	%
2009 Est. Households by Household Income	1,334.00		9,383.00		24,124.00	
Income Less than \$15,000	72	5.40	520	5.54	1,847	7.66
Income \$15,000 - \$24,999	62	4.65	570	6.07	2,043	8.47
Income \$25,000 - \$34,999	85	6.37	878	9.36	2,695	11.17
Income \$35,000 - \$49,999	190	14.24	1,445	15.40	4,095	16.97
Income \$50,000 - \$74,999	306	22.94	2,277	24.27	5,931	24.59
Income \$75,000 - \$99,999	248	18.59	1,735	18.49	3,785	15.69
Income \$100,000 - \$149,999	229	17.17	1,337	14.25	2,738	11.35
Income \$150,000 - \$249,999	99	7.42	450	4.80	745	3.09
Income \$250,000 - \$499,999	34	2.55	139	1.48	198	0.82
Income \$500,000 and more	9	0.67	33	0.35	46	0.19
2009 Est. Average Household Income	88,034.63		75,999.59		65,506.50	
2009 Est. Median Household Income	71,050.49		64,041.92		55,824.34	
2009 Est. Per Capita Income	33,141.78		29,180.02		25,351.49	
2009 Est. Household Type, Presence Own Children*	1,334.00		9,383.00		24,124.00	
Single Male Householder	113	8.47	835	8.90	2,237	9.27
Single Female Householder	126	9.45	1,066	11.36	3,020	12.52
Married-Couple Family, own children	435	32.61	2,733	29.13	6,390	26.49
Married-Couple Family, no own children	472	35.38	3,284	35.00	7,731	32.05
Male Householder, own children	21	1.57	157	1.67	474	1.96
Male Householder, no own children	17	1.27	135	1.44	480	1.99
Female Householder, own children	50	3.75	406	4.33	1,409	5.84
Female Householder, no own children	34	2.55	317	3.38	1,168	4.84
Nonfamily, Male Householder	39	2.92	256	2.73	712	2.95
Nonfamily, Female Householder	26	1.95	195	2.08	503	2.09
2009 Est. Households by Household Size*	1,334.00		9,383.00		24,124.00	
1-person household	240	17.99	1,901	20.26	5,257	21.79
2-person household	478	35.83	3,360	35.81	8,434	34.96
3-person household	280	20.99	1,875	19.98	4,763	19.74
4-person household	223	16.72	1,443	15.38	3,620	15.01
5-person household	83	6.22	553	5.89	1,392	5.77
6-person household	22	1.65	170	1.81	422	1.75
7 or more person household	9	0.67	81	0.86	236	0.98
2009 Est. Average Household Size	2.66		2.60		2.58	



Pop-Facts: Demographic Snapshot Report

Radius 1: BROOKSHIRE BLVD AT MOUNT HOLLY HUNTERSVILLE RD, CHARLOTTE, NC 28216, aggregate

Radius 2: BROOKSHIRE BLVD AT MOUNT HOLLY HUNTERSVILLE RD, CHARLOTTE, NC 28216, aggregate

Radius 3: BROOKSHIRE BLVD AT MOUNT HOLLY HUNTERSVILLE RD, CHARLOTTE, NC 28216, aggregate

Description	0.00 - 1.00 miles		0.00 - 3.00 miles		0.00 - 5.00 miles	
	Radius 1	%	Radius 2	%	Radius 3	%
2009 Est. Households by Presence of People*	1,334.00		9,383.00		24,124.00	

Households with 1 or more People under Age 18:

Married-Couple Family	454	34.03	2,852	30.40	6,749	27.98
Other Family, Male Householder	24	1.80	173	1.84	558	2.31
Other Family, Female Householder	55	4.12	471	5.02	1,682	6.97
Nonfamily, Male Householder	3	0.22	26	0.28	76	0.32
Nonfamily, Female Householder	1	0.07	3	0.03	17	0.07

Households no People under Age 18:

Married-Couple Family	453	33.96	3,164	33.72	7,372	30.56
Other Family, Male Householder	14	1.05	119	1.27	396	1.64
Other Family, Female Householder	29	2.17	251	2.68	895	3.71
Nonfamily, Male Householder	149	11.17	1,065	11.35	2,873	11.91
Nonfamily, Female Householder	152	11.39	1,257	13.40	3,507	14.54

2009 Est. Households by Number of Vehicles*	1,334.00		9,383.00		24,124.00	
No Vehicles	22	1.65	206	2.20	700	2.90
1 Vehicle	248	18.59	2,327	24.80	6,847	28.38
2 Vehicles	684	51.27	4,474	47.68	11,058	45.84
3 Vehicles	288	21.59	1,877	20.00	4,391	18.20
4 Vehicles	63	4.72	375	4.00	832	3.45
5 or more Vehicles	29	2.17	124	1.32	295	1.22

2009 Est. Average Number of Vehicles*	2.18	2.04	1.96
--	------	------	------

Family Households

2014 Projection	1,277	8,627	20,865
2009 Estimate	1,029	7,031	17,652
2000 Census	547	3,911	11,630
1990 Census	255	2,430	8,626
Growth 2009-2014	24.10%	22.70%	18.20%
Growth 2000-2009	88.12%	79.77%	51.78%
Growth 1990-2000	114.51%	60.95%	34.82%



Pop-Facts: Demographic Snapshot Report

Radius 1: BROOKSHIRE BLVD AT MOUNT HOLLY HUNTERSVILLE RD, CHARLOTTE, NC 28216, aggregate

Radius 2: BROOKSHIRE BLVD AT MOUNT HOLLY HUNTERSVILLE RD, CHARLOTTE, NC 28216, aggregate

Radius 3: BROOKSHIRE BLVD AT MOUNT HOLLY HUNTERSVILLE RD, CHARLOTTE, NC 28216, aggregate

Description	0.00 - 1.00 miles		0.00 - 3.00 miles		0.00 - 5.00 miles	
	Radius 1	%	Radius 2	%	Radius 3	%
2009 Est. Family Households by Household Income	1,029.00		7,031.00		17,652.00	
Income Less than \$15,000	20	1.94	129	1.83	830	4.70
Income \$15,000 - \$24,999	24	2.33	213	3.03	1,021	5.78
Income \$25,000 - \$34,999	46	4.47	532	7.57	1,591	9.01
Income \$35,000 - \$49,999	125	12.15	924	13.14	2,674	15.15
Income \$50,000 - \$74,999	242	23.52	1,878	26.71	4,899	27.75
Income \$75,000 - \$99,999	238	23.13	1,608	22.87	3,392	19.22
Income \$100,000 - \$149,999	196	19.05	1,152	16.38	2,343	13.27
Income \$150,000 - \$249,999	98	9.52	428	6.09	674	3.82
Income \$250,000 - \$499,999	32	3.11	134	1.91	184	1.04
Income \$500,000 and more	9	0.87	33	0.47	44	0.25
2009 Est. Average Family Household Income	99,754.86		86,127.83		73,178.62	
2009 Est. Median Family Household Income	81,119.25		72,857.90		63,829.08	
2009 Est. Families by Poverty Status*	1,029.00		7,031.00		17,652.00	
Income At or Above Poverty Level:						
Married-Couple Family, own children	457	44.41	2,791	39.70	6,647	37.66
Married-Couple Family, no own children	445	43.25	3,176	45.17	7,218	40.89
Male Householder, own children	26	2.53	180	2.56	475	2.69
Male Householder, no own children	5	0.49	63	0.90	338	1.91
Female Householder, own children	70	6.80	522	7.42	1,494	8.46
Female Householder, no own children	8	0.78	146	2.08	723	4.10
Income Below Poverty Level:						
Married-Couple Family, own children	2	0.19	24	0.34	121	0.69
Married-Couple Family, no own children	3	0.29	25	0.36	136	0.77
Male Householder, own children	7	0.68	45	0.64	105	0.59
Male Householder, no own children	0	0.00	4	0.06	37	0.21
Female Householder, own children	6	0.58	42	0.60	278	1.57
Female Householder, no own children	0	0.00	13	0.18	81	0.46
2009 Est. Pop Age 16+ by Employment Status*	2,641.00		18,222.00		47,415.00	
In Armed Forces	0	0.00	2	0.01	6	0.01
Civilian - Employed	1,884	71.34	13,025	71.48	32,805	69.19
Civilian - Unemployed	11	0.42	160	0.88	1,027	2.17
Not in Labor Force	747	28.28	5,035	27.63	13,577	28.63



Pop-Facts: Demographic Snapshot Report

Radius 1: BROOKSHIRE BLVD AT MOUNT HOLLY HUNTERSVILLE RD, CHARLOTTE, NC 28216, aggregate

Radius 2: BROOKSHIRE BLVD AT MOUNT HOLLY HUNTERSVILLE RD, CHARLOTTE, NC 28216, aggregate

Radius 3: BROOKSHIRE BLVD AT MOUNT HOLLY HUNTERSVILLE RD, CHARLOTTE, NC 28216, aggregate

Description	0.00 - 1.00 miles		0.00 - 3.00 miles		0.00 - 5.00 miles	
	Radius 1	%	Radius 2	%	Radius 3	%
2009 Est. Civ Employed Pop 16+ Class of Worker*	1,884.00		13,025.00		32,805.00	
For-Profit Private Workers	1,553	82.43	10,234	78.57	25,857	78.82
Non-Profit Private Workers	52	2.76	581	4.46	1,516	4.62
Local Government Workers	108	5.73	570	4.38	1,606	4.90
State Government Workers	66	3.50	492	3.78	1,190	3.63
Federal Government Workers	21	1.11	253	1.94	619	1.89
Self-Emp Workers	83	4.41	880	6.76	1,885	5.75
Unpaid Family Workers	0	0.00	15	0.12	133	0.41

2009 Est. Civ Employed Pop 16+ by Occupation*						
	1,884.00		13,025.00		32,805.00	
Management, Business, and Financial Operations	424	22.51	2,280	17.50	4,939	15.06
Professional and Related Occupations	397	21.07	2,524	19.38	5,715	17.42
Service	193	10.24	1,381	10.60	3,710	11.31
Sales and Office	483	25.64	4,058	31.16	10,107	30.81
Farming, Fishing, and Forestry	0	0.00	3	0.02	67	0.20
Construction, Extraction and Maintenance	158	8.39	1,222	9.38	3,313	10.10
Production, Transportation and Material Moving	229	12.15	1,557	11.95	4,953	15.10

2009 Est. Pop 16+ by Occupation Classification*						
	1,884.00		13,025.00		32,805.00	
Blue Collar	387	20.54	2,779	21.34	8,267	25.20
White Collar	1,304	69.21	8,861	68.03	20,761	63.29
Service and Farm	193	10.24	1,384	10.63	3,777	11.51

2009 Est. Workers Age 16+, Transportation To Work*						
	1,846.00		12,842.00		32,259.00	
Drove Alone	1,567	84.89	10,749	83.70	26,974	83.62
Car Pooled	170	9.21	1,494	11.63	3,870	12.00
Public Transportation	4	0.22	50	0.39	242	0.75
Walked	6	0.33	53	0.41	196	0.61
Motorcycle	3	0.16	32	0.25	51	0.16
Bicycle	0	0.00	0	0.00	16	0.05
Other Means	22	1.19	72	0.56	127	0.39
Worked at Home	73	3.95	392	3.05	783	2.43

2009 Est. Workers Age 16+ by Travel Time to Work*						
	1,773.00		12,450.00		31,475.00	
Less than 15 Minutes	170	9.59	1,410	11.33	4,623	14.69
15 - 29 Minutes	849	47.88	5,784	46.46	14,092	44.77
30 - 44 Minutes	554	31.25	3,766	30.25	9,053	28.76
45 - 59 Minutes	112	6.32	879	7.06	2,185	6.94
60 or more Minutes	87	4.91	611	4.91	1,522	4.84

2009 Est. Average Travel Time to Work in Minutes*						
	30.04		29.66		28.80	



Pop-Facts: Demographic Snapshot Report

Radius 1: BROOKSHIRE BLVD AT MOUNT HOLLY HUNTERSVILLE RD, CHARLOTTE, NC 28216, aggregate

Radius 2: BROOKSHIRE BLVD AT MOUNT HOLLY HUNTERSVILLE RD, CHARLOTTE, NC 28216, aggregate

Radius 3: BROOKSHIRE BLVD AT MOUNT HOLLY HUNTERSVILLE RD, CHARLOTTE, NC 28216, aggregate

Description	0.00 - 1.00 miles		0.00 - 3.00 miles		0.00 - 5.00 miles	
	Radius 1	%	Radius 2	%	Radius 3	%
2009 Est. Tenure of Occupied Housing Units	1,334.00		9,383.00		24,124.00	
Owner Occupied	1,201	90.03	8,397	89.49	20,455	84.79
Renter Occupied	133	9.97	986	10.51	3,669	15.21
2009 Occ Housing Units, Avg Length of Residence	5.72		6.49		7.51	
2009 Est. All Owner-Occupied Housing Values	1,201.00		8,397.00		20,455.00	
Value Less than \$20,000	15	1.25	178	2.12	345	1.69
Value \$20,000 - \$39,999	2	0.17	73	0.87	252	1.23
Value \$40,000 - \$59,999	4	0.33	89	1.06	450	2.20
Value \$60,000 - \$79,999	14	1.17	191	2.27	962	4.70
Value \$80,000 - \$99,999	53	4.41	369	4.39	1,876	9.17
Value \$100,000 - \$149,999	257	21.40	2,550	30.37	7,186	35.13
Value \$150,000 - \$199,999	427	35.55	2,925	34.83	5,535	27.06
Value \$200,000 - \$299,999	143	11.91	979	11.66	2,390	11.68
Value \$300,000 - \$399,999	89	7.41	383	4.56	585	2.86
Value \$400,000 - \$499,999	96	7.99	340	4.05	442	2.16
Value \$500,000 - \$749,999	60	5.00	199	2.37	263	1.29
Value \$750,000 - \$999,999	25	2.08	80	0.95	108	0.53
Value \$1,000,000 or more	16	1.33	40	0.48	61	0.30
2009 Est. Median All Owner-Occupied Housing Value	179,906.54		162,790.50		144,128.29	
2009 Est. Housing Units by Units in Structure*	1,482.00		10,351.00		26,155.00	
1 Unit Attached	13	0.88	134	1.29	474	1.81
1 Unit Detached	1,389	93.72	9,284	89.69	22,521	86.11
2 Units	7	0.47	95	0.92	258	0.99
3 to 19 Units	8	0.54	111	1.07	929	3.55
20 to 49 Units	0	0.00	0	0.00	61	0.23
50 or More Units	3	0.20	32	0.31	109	0.42
Mobile Home or Trailer	61	4.12	694	6.70	1,802	6.89
Boat, RV, Van, etc.	0	0.00	0	0.00	0	0.00



Pop-Facts: Demographic Snapshot Report

Radius 1: BROOKSHIRE BLVD AT MOUNT HOLLY HUNTERSVILLE RD, CHARLOTTE, NC 28216, aggregate

Radius 2: BROOKSHIRE BLVD AT MOUNT HOLLY HUNTERSVILLE RD, CHARLOTTE, NC 28216, aggregate

Radius 3: BROOKSHIRE BLVD AT MOUNT HOLLY HUNTERSVILLE RD, CHARLOTTE, NC 28216, aggregate

Description	0.00 - 1.00 miles		0.00 - 3.00 miles		0.00 - 5.00 miles	
	<i>Radius 1</i>	%	<i>Radius 2</i>	%	<i>Radius 3</i>	%
2009 Est. Housing Units by Year Structure Built	1,482.00		10,351.00		26,155.00	
Housing Units Built 1999 to 2009	854	57.62	5,558	53.70	10,984	42.00
Housing Unit Built 1995 to 1998	149	10.05	1,022	9.87	2,478	9.47
Housing Unit Built 1990 to 1994	141	9.51	846	8.17	1,986	7.59
Housing Unit Built 1980 to 1989	89	6.01	727	7.02	2,336	8.93
Housing Unit Built 1970 to 1979	73	4.93	656	6.34	2,443	9.34
Housing Unit Built 1960 to 1969	71	4.79	686	6.63	2,636	10.08
Housing Unit Built 1950 to 1959	60	4.05	565	5.46	1,823	6.97
Housing Unit Built 1940 to 1949	24	1.62	183	1.77	713	2.73
Housing Unit Built 1939 or Earlier	20	1.35	107	1.03	758	2.90
2009 Est. Median Year Structure Built **	2,000.33		1,999.69		1,995.62	

*In contrast to Claritas Demographic Estimates, "smoothed" data items are Census 2000 tables made consistent with current year estimated and 5 year projected base counts.

**1939 will appear when at least half of the Housing Units in this reports area were built in 1939 or earlier.

